

September 12, 1997
Lakehaven1989:mc/ko

Introduced By: Pete von Reichbauer

Proposed No.: 97-574

ORDINANCE NO. **12912**

AN ORDINANCE relating to the annexation of a 50.5-acre area known as Lakota Beach to the Lakehaven Utility District for the purpose of providing sewer service.

STATEMENT OF FACT:

1. A notice of intention proposing the annexation of a 50.5-acre area known as Lakota Beach to the Lakehaven Utility District for providing sewer service was filed with the County Council effective March 4, 1997.
2. Lakehaven Utility District has found the petition for annexation to be sufficient and has, by Resolution No. 97-818 concurred with the proposed annexation.
3. Lakehaven Utility District filed a Determination of Nonsignificance dated November 27, 1996 on the proposed annexation.
4. The County Council held a public hearing on the day of ^{6th} October, 1997 and has considered the criteria set forth in R.C.W. 57.02.040.

BE IT ORDAINED BY THE COUNCIL OF KING COUNTY:

SECTION 1. The annexation by Lakehaven Utility District of a 50.5-acre area known as Lakota Beach and described in Attachment A, is approved. This proposed annexation is consistent with R.C.W. 57.02.040.

SECTION 2. Lakehaven Utility District is the appropriate entity to serve the area proposed to be annexed.

1
2
3
4
5
6
7
8
9
10
11
12
13
14
15
16
17
18
19
20

SECTION 3. Completion of this annexation does not constitute County approval or disapproval of any other permits, certifications, or actions necessary to provide service to this annexation area.

INTRODUCED AND READ for the first time this 22nd day of

September, 1997.

PASSED by a vote of 12 to 0 this 17th day of November,

1997

KING COUNTY COUNCIL
KING COUNTY, WASHINGTON

Jane Hague
Chair

ATTEST:

William
Clerk of the Council

APPROVED this 24 day of November, 1997

Donald C. Am
King County Executive

Attachments: A. Legal Description
 B. Map

12912

EXHIBIT "A"

LEGAL DESCRIPTION OF THE LAKOTA BEACH ANNEXATION AREA

A portion of the Southwest quarter of Section 1, Township 21 North, Range 3 East, W.M., in King County, Washington, more particularly described as follows:

All of those portions within the plat of Lakota as recorded in Volume 21 of Plats, Page 33, records of King County, Washington, and of the plat of Lakota Beach Division No. 2 as recorded in Volume 22 of Plats, Page 12, records of King County, Washington, which lie in said Southwest quarter of Section 1;

TOGETHER WITH the following described parcel:

BEGINNING at a point on the East line of said plat of Lakota which is 1530 feet North and 830 feet west of the Southeast corner of Government Lot 3 of said Section 1; THENCE North $89^{\circ}47'05''$ East, 270 feet; THENCE North to the northerly line of said Government Lot 3; THENCE along said line southwesterly to the Northeast corner of Lot 1 of said plat of Lakota; THENCE South to the POINT OF BEGINNING.

RECEIVED

97 MAR -4 AM 9:36

CLERK
KING COUNTY COUNCIL

LAKOTA BEACH ANNEXATION

LAKEHAVEN UTILITY DISTRICT DISTRICT BOUNDARIES MAP

RECEIVED

97 MAR -4 AM 9:36

CLERK KIMRAY COUNTY COUNCIL SEWER DISTRICT CITY OF KENT (S)

LEGEND

- BOUNDARIES
- LAKEHAVEN DISTRICT BOUNDARY
- CITY OF FEDERAL WAY
- OTHER CITIES
- WATER SERVICE AREA
- SEWER SERVICE AREA

SITE



SOUND

REDONDO WWTP

R.3 E. T.22 N. R.4 E. T.21 N.

LAKOTA WWTP

LAKEHAVEN UTILITY DISTRICT OFFICES

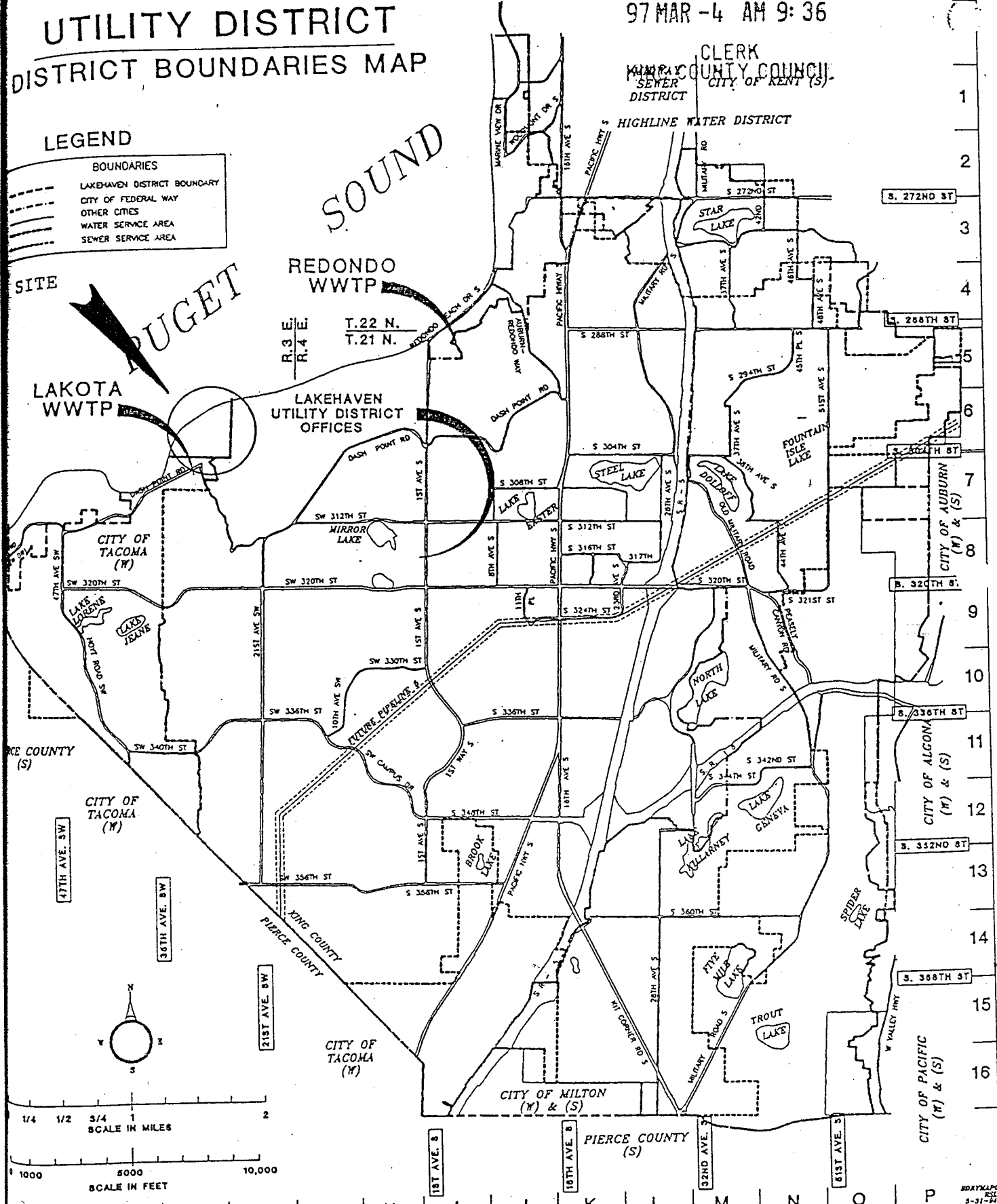

1
2
3
4
5
6
7
8
9
10
11
12
13
14
15
16